

## Curb-and-road gully inlet D400 H220/100, frame made of grey cast iron with flange, grating made of ductile iron, hinged with locking

- Standard:** PN – EN 124-2:2015-7
- Material:** Frame – grey cast iron GJL-250  
Grating – ductile iron GJS-500-7
- Marking:** LK, D400, EN124-2, IO-CERT,  
Construction mark B
- Total frame height:** H220 mm
- For installation in a curb with a height of H120 mm**
- Water drainage area: approx. 680.4 cm<sup>2</sup>**
- Locking:** bolt, screw
- Application:** for installation in areas classified as Group 4 (according to PN-EN 124-1)

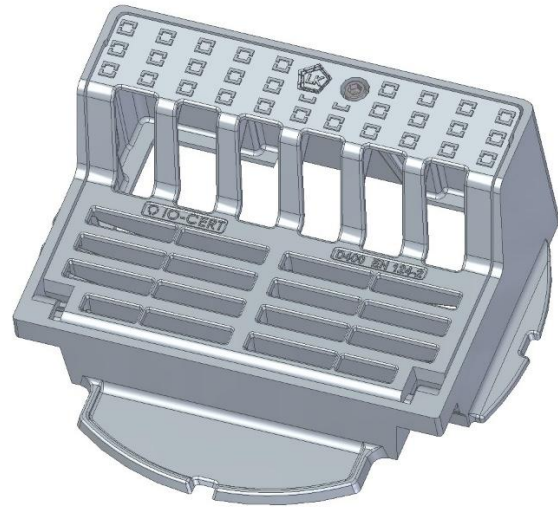

Installation of a sediment basket (type D1 or C3) is possible using an adapter (index 81161).

| Product name   | Index | Qty / pallet |
|--|-------|--------------|
| <b>Curb-and-road gully inlet D400 H220/100</b> , frame made of grey cast iron, grating made of ductile iron, hinged with locking | 81517 | 12           |

PRZEKRÓJ B-B

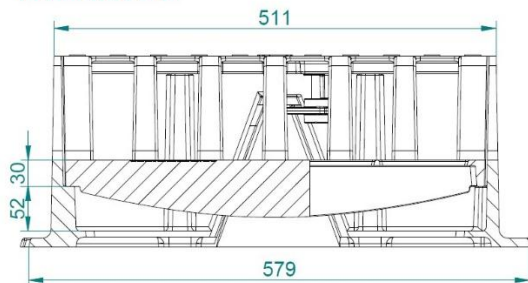

PRZEKRÓJ A-A

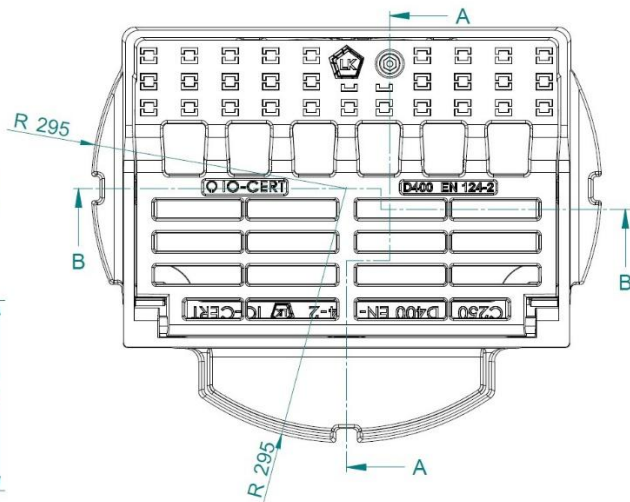
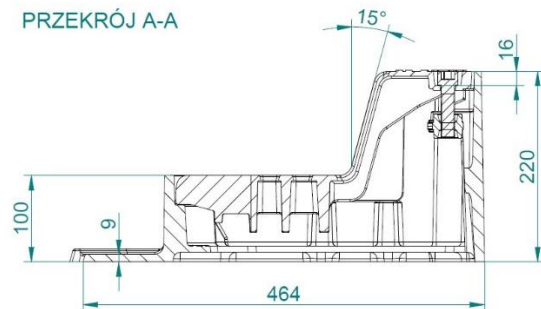

Notes: **Products are not painted.**

**Custom branding:** upon prior arrangement, it is possible to place the customer's name on the grating. Follow installation, operation, and maintenance instructions.

**Product warranty:** 36 months

The product cross-section shown in the drawing is for reference only—we reserve the right to introduce design changes to improve the product.